

**Dimension: (UNIT:mm)**

A	36.1 ± 0.6
B	26.0 ± 0.5
C	34.7 ± 0.25
D	25.0 ± 0.3
E	32.0 ± 0.5
F	23.5Min
G	14.4 ± 0.25
H	6.0Min

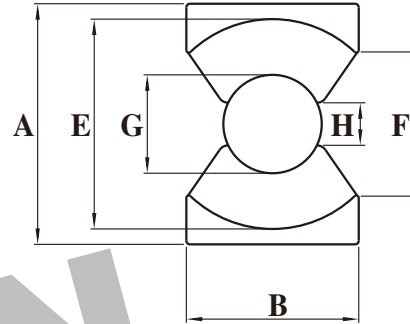
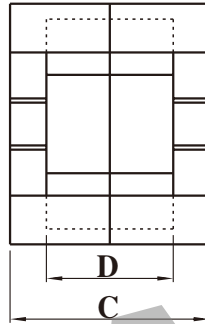

**Test conditions**

AL: F=10.0KHz U=0.3V N=10Ts

**Effective parameter**

C1(mm) <sup>-1</sup>	Ae(mm <sup>2</sup> )	Le(mm)	Ve(mm <sup>3</sup> )	Weight(g)
0.454	190	86.1	16300	≈73

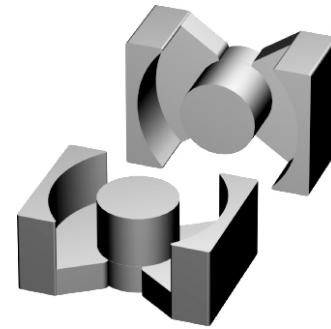

Core sets for general purpose transformers and Power applications.

Clamping force for AI measurements,80+/-20N.

**Properties of core sets under power conditions**

Grade	AL (nH)	μe	AIR GAP μm	Type number
P3	315 ± 3%	≈ 114	≈ 920	PQ3535-P3
	400 ± 3%	≈ 144	≈ 690	PQ3535-P3
	630 ± 3%	≈ 227	≈ 400	PQ3535-P3
	1000 ± 3%	≈ 361	≈ 230	PQ3535-P3
	1600 ± 5%	≈ 577	≈ 120	PQ3535-P3
P4	5200 ± 25%	≈ 1880	≈ 0	PQ3535-P3
P4	5200 ± 25%	≈ 1880	≈ 0	PQ3535-P4
HQ2KA	4700 ± 25%	≈ 1700	≈ 0	PQ3535-HQ2KA
HQ2K	315 ± 3%	≈ 114	≈ 920	PQ3535-HQ2K
	400 ± 3%	≈ 144	≈ 690	PQ3535-HQ2K
	630 ± 3%	≈ 227	≈ 400	PQ3535-HQ2K
	1000 ± 3%	≈ 361	≈ 230	PQ3535-HQ2K
	1600 ± 5%	≈ 577	≈ 120	PQ3535-HQ2K
HQ2K	4570 ± 25%	≈ 1650	≈ 0	PQ3535-HQ2K

Grade	B (mT)at	Core loss (w) at			
	H=250 A/m F=25KHz T=100℃	F=25 KHz B̂=200mT T=100℃	f=100 KHz B̂=100mT T=100℃	F=100 KHz B̂=200mT T=100℃	F=400 KHz B̂=50mT T=100℃
P3	≥320	≤2.0	≤2.1	-	-
P4	≥320	-	≤1.6	≤10	-
HQ2KA	≥340	-	≤1.2	≤8.0	≤3.0
HQ2K	≥320	-	≤1.8	-	≤3.1

**Properties of core sets under power conditions (continued)**

Grade	B (mT)at	Core loss (w) at			
	H=250 A/m F=25KHz T=100℃	F=500 KHz B̂=50mT T=100℃	F=500 KHz B̂=100mT T=100℃	F=1.0 MHz B̂=30mT T=100℃	F=3.0MHz B̂=10mT T=100℃
P3	≥320	-	-	-	-
P4	≥320	-	-	-	-
HQ2KA	≥340	≤6.1	-	-	-
HQ2K	≥320	-	-	-	-

**Note:**

- 1:Document is the property of FUAN Inc & is not allow to be duplicated without authorization
- 2:RoHS compliant.